

LONGEVIS

AN INSULATION AND KIT EXPERT

上海荣家贸易发展有限公司



VAG

## 闸阀类产品

DN 40 ... 300



**LONGEVIS**

*AN INSULATION AND KIT EXPERT*

上海荣家贸易发展有限公司



## 闸阀（短法兰间距，内螺杆）

PN 6/10 – DN 40 ... 300



材料\编号	KAT-A 1162-E-F4	KAT-A 1162-M-F4
BODY ( 阀身 )	Cast iron	Cast iron
Bonnet ( 阀罩 )	Cast iron	Cast iron
Wedge ( 阀块 )	Cast iron	Cast iron
Bonnet bolts ( 阀罩螺母 )	Stainless steel	Stainliss steel
Body and wedge seat rings ( 阀身、阀块密封 )	Stainless steel	Brass
O-rings ( O型圈 )	Viton	EPDM
Stem ( 阀杆 )	Stainless steel	Stainless steel
Stem nut ( 阀杆螺母 )	Cast iron	Brass
Stem bearing ( 阀杆轴承 )	Cast iron	Brass

# LONGEVIS

AN INSULATION AND KIT EXPERT

上海荣家贸易发展有限公司

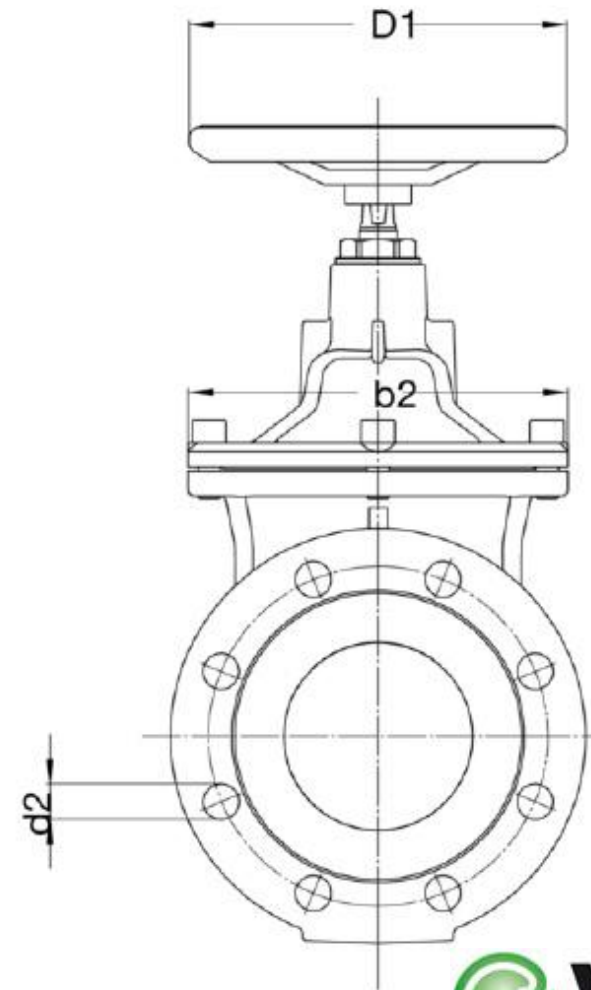
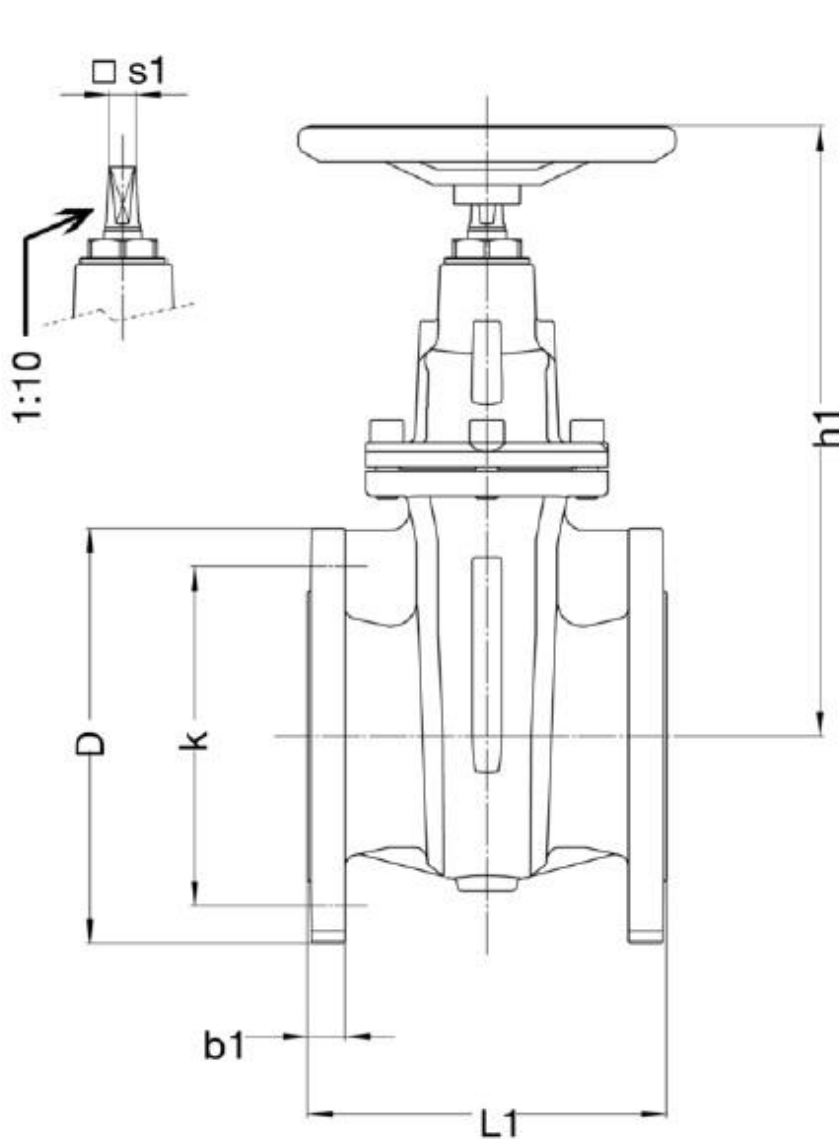

 **VAG**

PN 6/10 - DN 40 ... 300

# LONGEVIS

## AN INSULATION AND KIT EXPERT

上海荣家贸易发展有限公司

压力等级：  
PN10

DN		40	50	65	80	100	125	150	200	250	300
D	[mm]	150	165	185	200	220	250	285	340	395	445
D1	[mm]	150	150	150	150	200	200	200	200	300	300
L1	[mm]	140	150	170	180	190	200	210	230	250	270
b1	[mm]	18	20	20	22	24	26	26	26	28	28
b2	[mm]	140	140	176	176	201	238	263	340	388	445
d2	[mm]	19	19	19	19	19	19	23	23	23	23
h1	[mm]	225	235	280	280	330	380	420	505	595	675
k	[mm]	110	125	145	160	180	210	240	295	350	400
s1	[mm]	12	12	12	12	14	14	14	14	19	19
No.of holes		4	4	4	8	8	8	8	8	12	12
Turns/stroke		14	16	20	24	29	29	34	45	54	66
Weight approx.	[kg]	9.50	11.00	15.50	17.00	23.00	33.50	42.00	61.50	95.00	127.00
Volume approx.	[m3]	0.006	0.007	0.011	0.013	0.018	0.025	0.033	0.052	0.078	0.107



压力等级：  
PN6

DN		40	50	65	80	100	125	150	200	250	300
D	[mm]	150	165	185	200	220	250	285	340	395	445
D1	[mm]	150	150	150	150	200	200	200	200	300	300
L1	[mm]	140	150	170	180	190	200	210	230	250	270
b1	[mm]	18	20	20	22	24	26	26	26	28	28
b2	[mm]	140	140	176	176	201	238	263	340	388	445
d2	[mm]	14	14	14	19	19	19	19	19	19	23
h1	[mm]	225	235	280	280	330	380	420	505	595	675
k	[mm]	100	110	130	150	170	200	225	280	335	395
s1	[mm]	12	12	12	12	14	14	14	14	19	19
No.of holes		4	4	4	4	4	8	8	8	12	12
Turns/stroke		14	16	20	24	29	29	34	45	54	66
Weight approx.	[kg]	9.50	11.00	15.50	17.00	23.00	33.50	42.00	61.50	95.00	127.00
Volume approx.	[m3]	0.006	0.007	0.011	0.013	0.018	0.025	0.033	0.052	0.078	0.107



LONGEVIS

AN INSULATION AND KIT EXPERT

上海荣家贸易发展有限公司



## 闸阀（长法兰间距，内螺杆）

PN 10/16 – DN 40 ... 300



材料\编号	KAT-A 1162-E-F5	KAT-A 1162-M-F5
BODY ( 阀身 )	Cast iron(铸铁)	Cast iron(铸铁)
Bonnet ( 阀罩 )	Cast iron(铸铁)	Cast iron(铸铁)
Wedge ( 阀块 )	Cast iron(铸铁)	Cast iron(铸铁)
Bonnet bolts ( 阀罩螺母 )	Stainless steel ( 不锈钢 )	Stainless steel ( 不锈钢 )
Body and wedge seat rings ( 阀身、阀块密封 )	Stainless steel ( 不锈钢 )	Brass ( 黄铜 )
O-rings ( O型圈 )	Viton(氟化橡胶)	EPDM(三元乙丙橡胶)
Stem ( 阀杆 )	Stainless steel ( 不锈钢 )	Stainless steel ( 不锈钢 )
Stem nut ( 阀杆螺母 )	Cast iron(铸铁)	Brass ( 黄铜 )
Stem bearing ( 阀杆轴承 )	Cast iron(铸铁)	Brass ( 黄铜 )

# LONGEVIS

AN INSULATION AND KIT EXPERT

上海荣家贸易发展有限公司

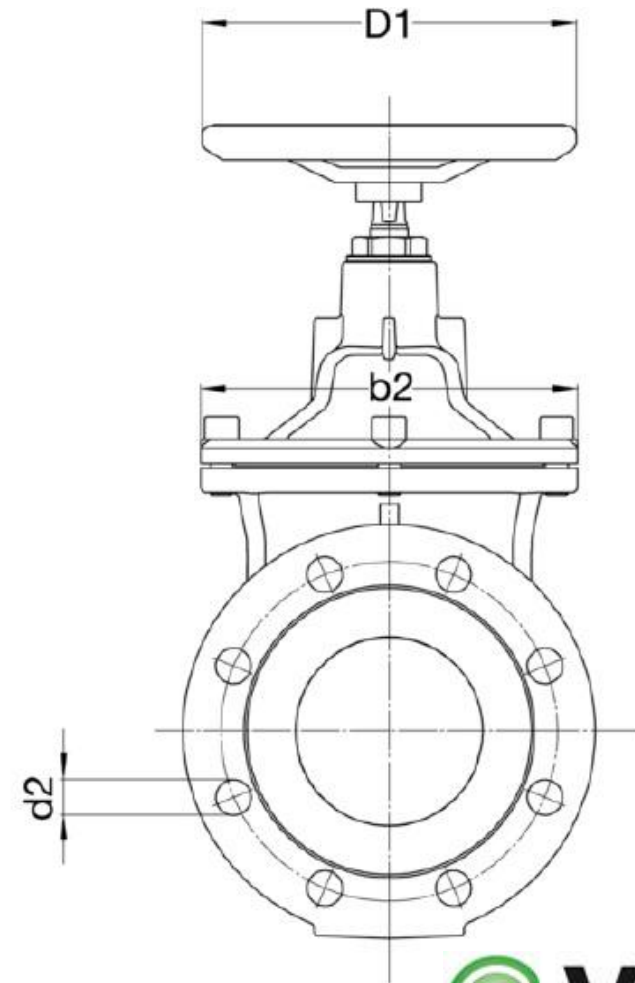
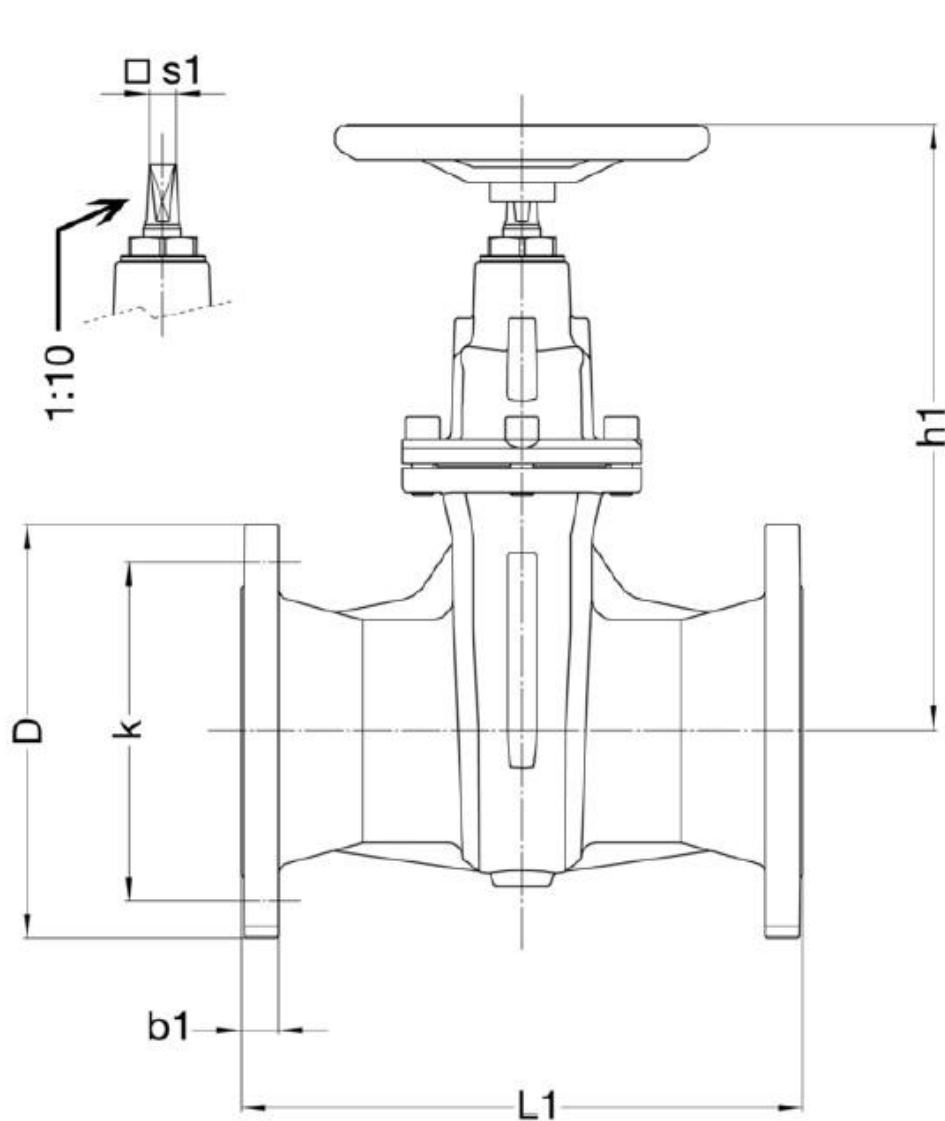

PN 10/16 - DN 40 ... 300

压力等级：  
PN16

DN		40	50	65	80	100	125	150	200	250	300
D	[mm]	150	165	185	200	220	250	285	340	405	460
D1	[mm]	150	150	150	150	200	200	200	200	300	300
L1	[mm]	240	250	270	280	300	325	350	400	450	500
b1	[mm]	18	20	20	22	24	26	26	30	32	32
b2	[mm]	140	140	176	176	201	238	263	340	388	445
d2	[mm]	19	19	19	19	19	19	23	23	28	28
h1	[mm]	225	235	280	280	330	380	420	505	595	675
k	[mm]	110	125	145	160	180	210	240	295	355	410
s1	[mm]	12	12	12	12	14	14	14	14	19	19
No.of holes		4	4	4	8	8	8	8	12	12	12
Turns/stroke		14	16	20	24	29	29	34	45	54	66
Weight approx.	[kg]	11.00	13.00	18.00	20.50	27.50	40	50.00	81.50	125.00	167.00
Volume approx.	[m3]	0.010	0.013	0.018	0.021	0.029	0.041	0.056	0.091	0.145	0.208





# LONGEVIS

## AN INSULATION AND KIT EXPERT

上海荣家贸易发展有限公司

压力等级：  
PN10

DN		200	250	300
D	[mm]	340	395	445
D1	[mm]	200	300	300
L1	[mm]	400	450	500
b1	[mm]	26	28	28
b2	[mm]	340	388	445
d2	[mm]	23	23	23
h1	[mm]	505	595	675
k	[mm]	295	350	400
s1	[mm]	14	19	19
No.of holes		8	12	12
Turns/stroke		45	54	66
Weight approx.	[kg]	61.50	95.00	127.00
Volume approx.	[m3]	0.091	0.145	0.208



LONGEVIS

AN INSULATION AND KIT EXPERT

上海荣家贸易发展有限公司



PN 6/10 – DN 40 ... 300

## 闸阀（外部螺杆）

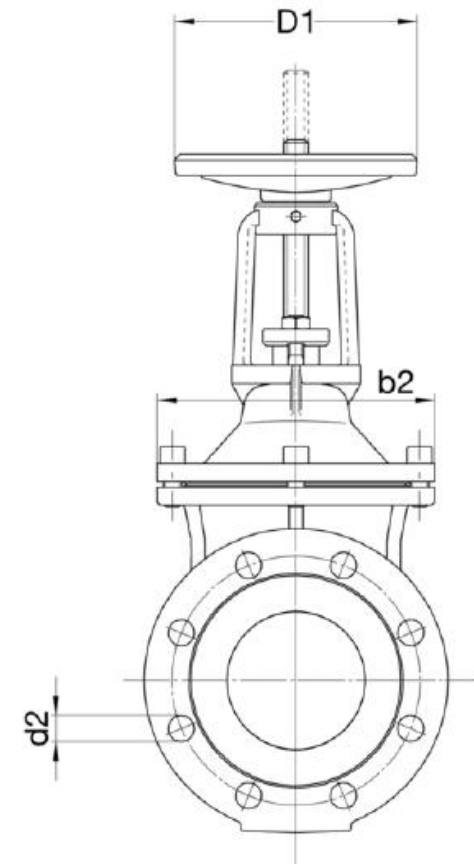
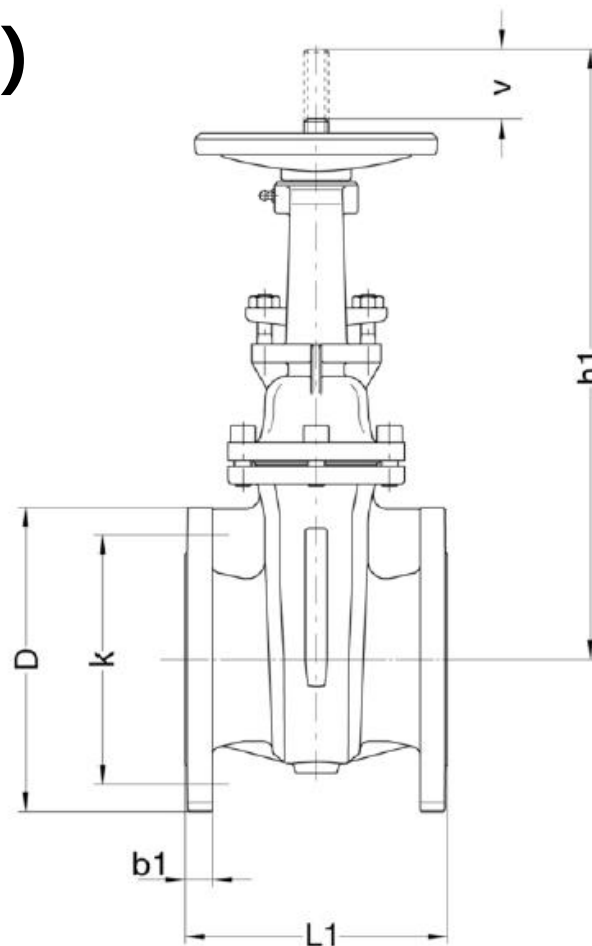

# LONGEVIS

## AN INSULATION AND KIT EXPERT

上海荣家贸易发展有限公司

压力等级：  
PN6

DN		40	50	65	80	100	125	150	200	250	300
D	[mm]	150	165	185	200	220	250	285	340	395	445
D1	[mm]	160	160	160	160	200	200	200	250	315	400
L1	[mm]	140	150	170	180	190	200	210	230	250	270
b1	[mm]	18	20	20	22	24	26	26	26	28	28
b2	[mm]	140	140	176	176	201	238	263	340	388	445
d2	[mm]	14	14	14	19	19	19	19	19	19	23
h1	[mm]	315	340	390	445	515	635	730	930	1155	1345
k	[mm]	100	110	130	150	170	200	225	280	335	395
v	[mm]	260	275	305	345	395	485	555	705	865	1000
No.of holes		4	4	4	4	4	8	8	8	12	12
Turns/stroke		14	16	20	24	29	29	34	45	54	66
Weight approx.	[kg]	11.0	13.00	17.00	21.00	28.00	36.00	48.00	85.00	119.00	175.00
Volume approx.	[m3]	0.010	0.011	0.014	0.017	0.024	0.036	0.048	0.086	0.132	0.189



压力等级：  
PN10

DN		40	50	65	80	100	125	150	200	250	300
D	[mm]	150	165	185	200	220	250	285	340	395	445
D1	[mm]	160	160	160	160	200	200	200	250	315	400
L1	[mm]	140	150	170	180	190	200	210	230	250	270
b1	[mm]	18	20	20	22	24	26	26	26	28	28
b2	[mm]	140	140	176	176	201	238	263	340	388	445
d2	[mm]	19	19	19	19	19	19	23	23	23	23
h1	[mm]	315	340	390	445	515	635	730	930	1155	1345
k	[mm]	110	125	145	160	180	210	240	295	350	400
v	[mm]	260	275	305	345	395	485	555	705	865	1000
No.of holes		4	4	4	8	8	8	8	8	12	12
Turns/stroke		14	16	20	24	29	29	34	45	54	66
Weight approx.	[kg]	12.00	14.00	18.00	21.00	29.00	37.00	51.00	83.00	121.00	177.00
Volume approx.	[m3]	0.010	0.011	0.014	0.017	0.024	0.036	0.048	0.086	0.132	0.189



压力等级：  
PN16

DN		40	50	65	80	100	125	150	200	250	300
D	[mm]	150	165	185	200	220	250	285	340	405	460
D1	[mm]	200	200	250	250	250	250	250	315	400	500
L1	[mm]	240	250	270	280	300	325	350	400	450	500
b1	[mm]	18	20	20	22	24	26	26	30	32	32
b2	[mm]	140	140	176	176	201	238	263	340	388	445
d2	[mm]	19	19	19	19	19	19	23	23	28	28
h1	[mm]	315	340	390	445	515	635	730	930	1155	1345
k	[mm]	110	125	145	160	180	210	240	295	355	410
v	[mm]	310	325	385	410	475	540	600	750	895	1020
No.of holes		4	4	4	8	8	8	8	12	12	12
Turns/stroke		14	16	20	24	29	29	34	45	54	66
Weight approx.	[kg]	20.00	24.00	33.00	40.00	50.00	65.00	83.00	143.00	216.00	294.00
Volume approx.	[m3]	0.016	0.017	0.030	0.038	0.047	0.062	0.080	0.150	0.244	0.350

